

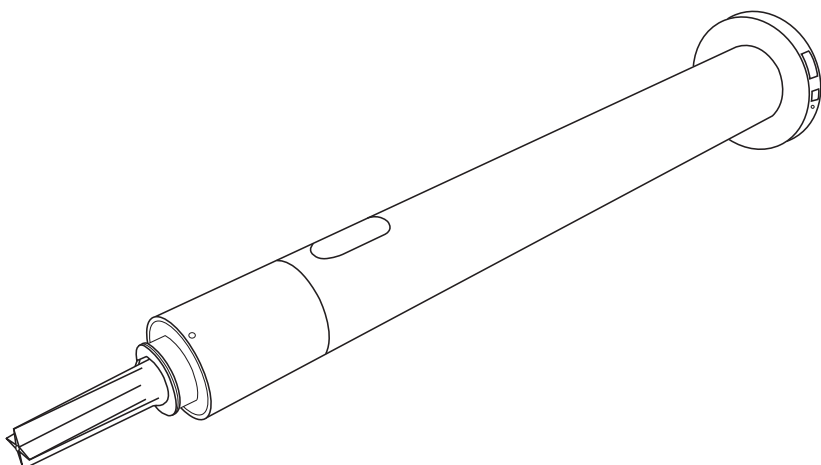

Roll Up WireFree™ IR



Installation instructions

Safety

- This Somfy product must be installed by a professional motorization and home automation installer, for whom these instructions are intended.
- Before installation, check that this product is compatible with the associated equipment and accessories.
- These instructions describe how to install, commission and use this product.
- Moreover, the installer must comply with current standards and legislation in the country in which the product is being installed, and inform his customers of the operating and maintenance conditions for the product.
- Any use outside the sphere of application specified by Somfy is not approved. Such use, or any failure to comply with the instructions given herein will invalidate the warranty, and Somfy refuses to accept liability.

Compatible blinds

Venetian blinds / Silhouette blinds

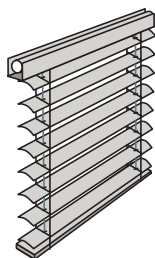

Roman shades

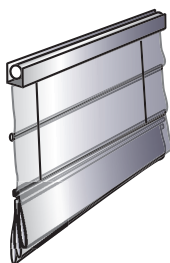

Roller blinds

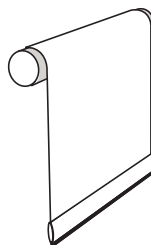

General safety instructions

The safety instructions that must be observed, besides the usual rules, are explained in these instructions and in the attached «Safety Instructions» document.

Never immerse the motor in liquid!



Avoid impacts!

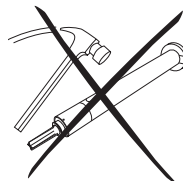

Never drill holes in the motor!

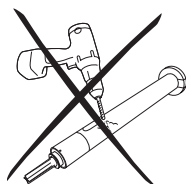

Do not drop it!



Installation

Motor preparation

- 1) Fit the crown (a) and drive wheel (b) to the motor.
- 2) Measure the length (L) between the middle of the drive wheel and the head end.

Tube preparation

- 1) Cut the tube to the required length. Deburr the tube and remove the debris.

Motor/tube assembly

- 1) Slide the motor into the tube. Insert the wheel/drive by aligning the wheel to the tube profile. Insert the motor half way and then slide the crown down the motor and insert it in the tube. Finally, push the motor inside the tube.
- 2) Not required, but if needed, fix the tube to the motor with self-tapping screws or steel pop rivets depending on the dimension (L).

Mounting the motorized tube on the brackets

- a) Standard bracket
- b) Motor plate for specific bracket

Wiring

- 1) Connect the battery pack to the motor
- 2) Connect the IR sensor to the motor

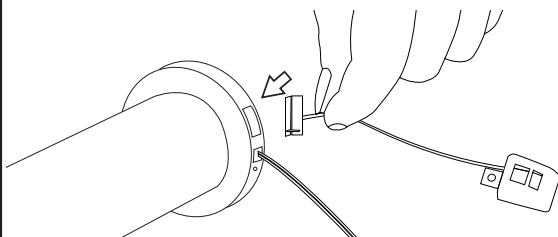
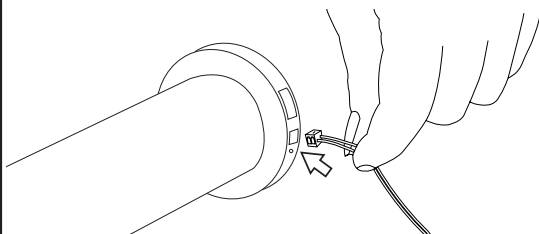
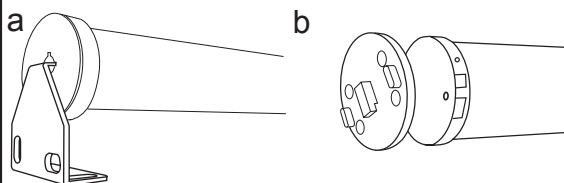
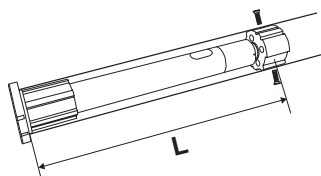
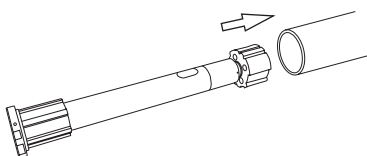
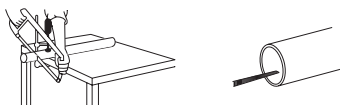
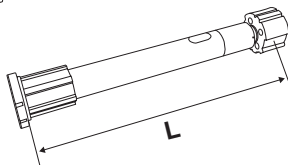
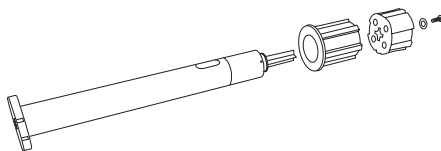

Commissioning

Checking the direction of rotation

Press the IR control UP button:

a) If the shade is raised, the direction of rotation is correct: move onto the section entitled «Adjusting the end limits».

b) If the shade is lowered, the direction of rotation is incorrect: move onto the next step.

Press the IR control STOP button until the shade jogs: the direction of rotation has been modified.

Press the IR control UP button to check the direction of rotation.

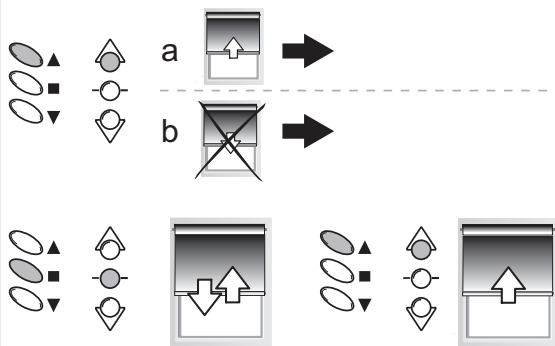

Adjusting the end limits

The limits can be set in any sequence.

1) Press and hold the UP button to move the shade to the desired up position.

2) Press simultaneously the STOP and DOWN buttons and release them once the shade begins to move. The UP LIMIT is memorized.

3) Press the STOP button when it reaches the desired down position.

If necessary to adjust the down position, press and hold the UP or DOWN button.

4) Press simultaneously the STOP and UP buttons and release them when the shade begins to move.

The Down limit is memorized

The shade moves up and will stop at its upper limit.

5) To confirm the ends limits press and hold the STOP button until the shade jogs. The ends limit are recorded.

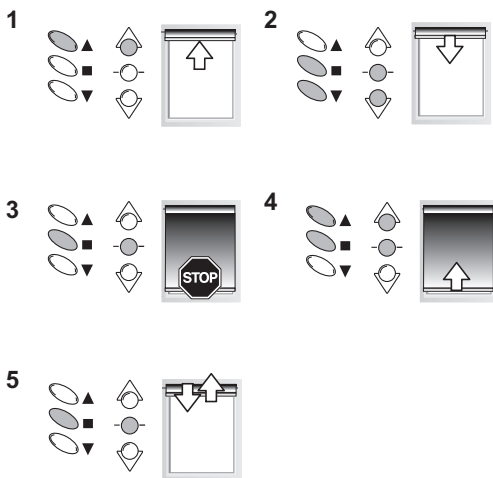

Use

Mode Selection

By factory default, the motor is in Tilting mode but you can change from a mode to another.

To change from a Tilting mode to a Roller mode, follow the instruction.

1) Roller Mode

Move the shade to the UP or DOWN end limit.

Press the UP and DOWN buttons simultaneously until the shade jogs.

Press the UP and STOP buttons simultaneously until the shade jogs.

The motor is in Roller Mode.

2) Tilting mode

Move the shade to the UP or DOWN end limit.

Press the UP and DOWN buttons simultaneously until the shade jogs.

Press the DOWN and STOP buttons simultaneously until the shade jogs.

The motor is in Tilting Mode.

MY position

1) Recording MY position.

To set the MY position, move the shade to the desired position using the UP and DOWN buttons then press and hold the STOP button until the shade jogs.

2) Changing the MY position

To change the MY position go to the new desired MY position with the UP and DOWN buttons then press and hold the STOP button until the shade jogs.

3) Delete the MY position

To delete the MY position, move to this position and press and hold the STOP button until the shade jogs.

ROLLER MODE

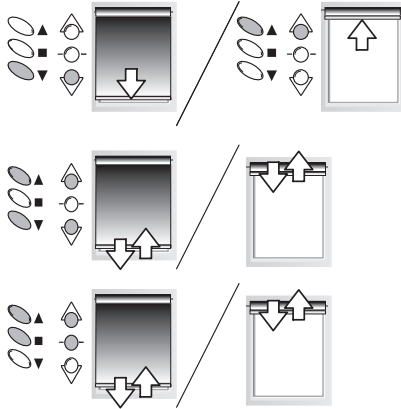

TILTING MODE

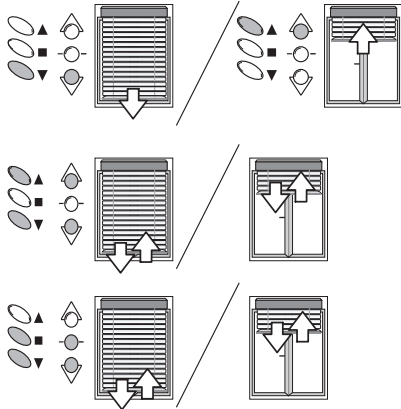

UP, DOWN and MY

1) To move the shade from a LIMIT to the other LIMIT, press briefly the UP or DOWN button.

2) To stop the shade, press the STOP button.

3) To move the shade to the MY position, press briefly the STOP button.

4) In Tilting mode, to orientate the slats, press and hold the UP or DOWN button until the slats reach the desired position.

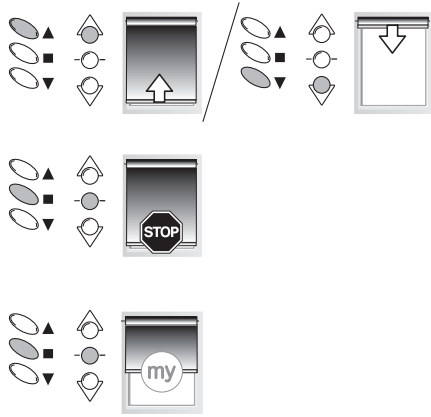

Assign/Deleting a channel

Only with the IR8 transmitter.

1) Assign a channel

Note : By factory default, the motor is paired to ALL channels on the transmitter. To designate one channel to a particular blind, the user must first delete unwanted channels (see step DELETE A CHANNEL).

To enter in programming mode: Press on the transmitter prog button until the shade jogs.

To program one channel : press on key 1 and next on the key of the channel to program (1 to 8) or channel group until the shade jogs.

To exit programming mode: press on the transmitter prog button until the shade jogs..

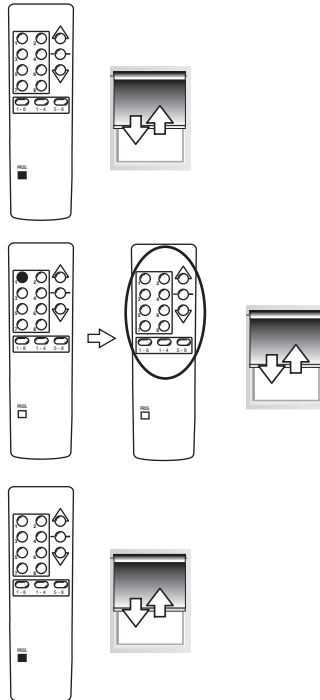

2) Delete a channel

To enter in programming mode: Press on the transmitter prog button until the shade jogs.

To erase one channel: press on key 8 and next on the key of the channel to remove (1 to 8) or channel group until the shade jogs.

To erase all channels: press on key 8 and next on key 1_8 until the motor shade jogs..

To exit programming mode : press on the transmitter prog button until the shade jogs..

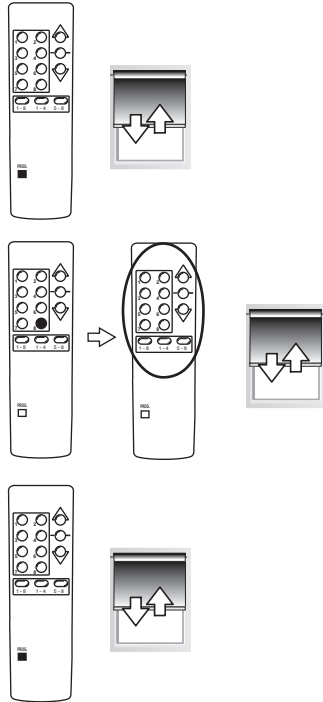

Change the direction of rotation

Move the shade to the UP or DOWN end limit.

Press the UP and DOWN buttons simultaneously until the shade jogs.

Press the UP, STOP and DOWN buttons simultaneously until the shade jogs again.

Press the UP button to check the new direction of rotation.

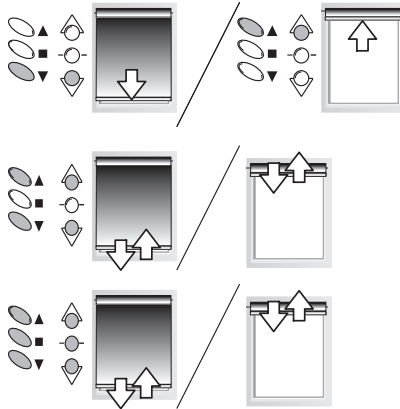

End limit re- adjustment

UP LIMIT

- 1) Press the UP button, to move the shade to the LIMIT to be readjusted.
- 2) Press the UP and DOWN buttons simultaneously until the shade jogs.
- 3) Press the UP or DOWN button to move the shade to the new desired position.
- 4) To confirm the new limit press the STOP button until the shade jogs

DOWN LIMIT

- 1) Press the DOWN button, to move the shade to the LIMIT to be readjusted.
- 2) Press the UP and DOWN buttons simultaneously until the shade jogs.
- 3) Press the UP or DOWN button to move the shade to the new desired position.
- 4) To confirm the new limit press the STOP button until the shade jogs

Erase the memory of the motor.

N.B.: This reset deletes all control points and intermediate positions programmed.
The motor returns to factory mode.

Press and hold the «prog» button for 12s until the shade jogs 3 times. The first at 2s, the second at 7s and the third at 12s.

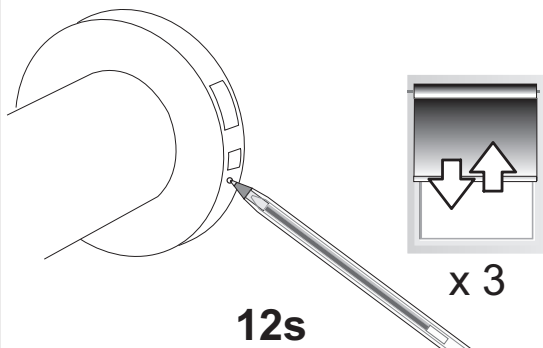
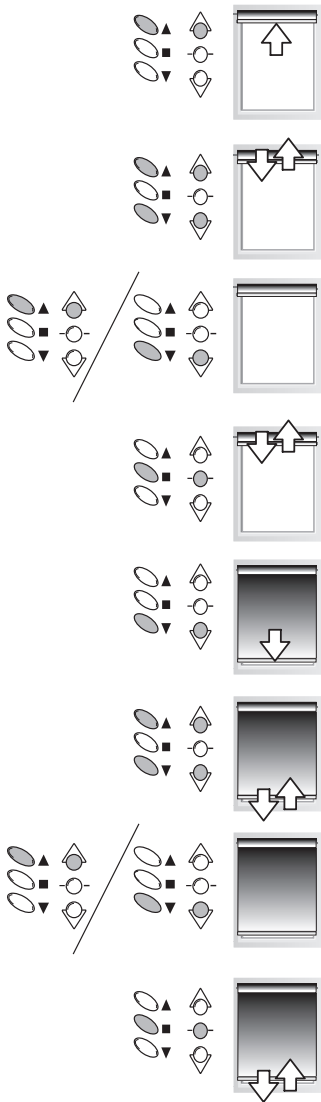

Technical data

Voltage	12V
Power source	AA 1.5V Lithuim (x8)
Operating temperature	0°C / 60 °C
Protection rating	IP 30
Torque	1.1 Nm
Average Speed	27 rpm

TROUBLESHOOTING

If the motor does not move :

- check the wiring connection.
- make sure the batteries are new.
- if using battery tube, make sure the batteries are installed with the correct polarity.
- check the batteries of the remote control.
- make sure the remote control is IR1 or IR8.

If the motor stops working after excessive use wait for the motor to cool 5 minutes.

If the limits are not accurate, readjust the limits.

If the motor stops operating normally, the battery voltage may be too low. Replace batteries.

Somfy worlwide

Argentina: Somfy Argentina

Tel: +55 11 (0) 4737-3700

Australia: Somfy PTY LTD

Tel: +61 (2) 8845 7200
Fax: +61 (0) 2 9638 0075

Austria: Somfy GesmbH

Tel: +43 (0) 662 / 62 53 08 - 0
Fax: +43 (0) 662 / 62 53 08 - 22

Belgium: Somfy Belux

Tel: +32 (0) 2 712 07 70
Fax: +32 (0) 2 725 01 77

Brasil: Somfy Brasil Ltda

Osasco - SP - Brasil
Tel/fax: +55 11 3695 3585

Canada: Somfy ULC

Tel: +1 (0) 905 564 6446
Fax: +1 (0) 905 564 6448

China: Somfy China Co. Ltd

Tel: +8621 (0) 6280 9660
Fax: +8621 (0) 6280 0270

Croatia : Somfy Predstavništvo

Tel: +385 (0) 51 502 640

Cyprus : Somfy Middle East

Tel: +357(0) 25 34 55 40
Fax: +357(0) 25 34 19 48

Czech Republic: Somfy, spol. sr.o.

Tel: (+420) 296 372 486-7
Fax: (+420) 272 937 846

Denmark: Somfy Nordic Danmark

Tel: +45 65 32 57 93
Fax: +45 65 32 57 94

Export: Somfy Export

Tel: + 33 4 50 96 70 76
Tel: + 33 4 50 96 75 53
Fax: + 33 4 50 96 70 91

Finland: Somfy Nordic AB Finland

Tel: +358 (0)9 57 130 230
Fax: +358 (0)9 57 130 231

France : Somfy France

Tel. : +33 (0) 820 374 374
Fax : +33 (0) 820 002 074
Tel. : +33 (0) 810 055 055

Germany: Somfy GmbH

Tel: +49 (0) 7472 930 0
Fax: +49 (0) 7472 930 9 (logistic)

Greece: SOMFY HELLAS S.A.

Tel: +30 210 6146768
Fax: +30 210 6120745

Hong Kong: Somfy Co. Ltd

Tel: +852 (0) 2523 6339
Fax: +852 (0) 2815 0716

Hungary : Somfy Kft

Tel: +36 1814 5120
Fax: +36 1814 5121

India: Somfy India PVT Ltd

Tel : +(91) 11 4165 9176
Fax: +(91) 11 4166 3080

Indonesia: Somfy Jakarta

Tel: +(62) 21 719 3620
Fax: +(62) 21 719 7447

Iran: Somfy Iran

Tel: +98-217-7951036
Fax : +98-217-7951036

Israel: Sisa Home Automation Ltd

Tel: +972 (0) 3 952 55 54

Italy: Somfy Italia s.r.l

Tel: +39-024847181
Fax: +39-024455794

Japan: SOMFY KK

Tel: +81 (0)45 481 6800
Fax: +81 (0)45 481 6915

Jordan: Somfy Jordan

Tel: +962-6-5821615

Kingdom of Saudi Arabia:

Somfy Saoudi
Riyadh :
Tel/Fax: +966 1 47 23 020
Tel/Fax: +966 1 47 23 203
Jeddah :
Tel: +966 2 69 83 353
Fax: +966 2 25 75 938

Kuwait: Somfy Kuwait

Tel/Fax: +965 4348906

Lebanon:

Tel: +961 (0) 1 391 224
Fax: +961 (0) 1 391 228

Malaysia: Somfy Malaysia: +60 (0) 3 228 74743

Mexico: Somfy Mexico SA de CV

Tel: 52 (55) 4777 7770
Fax: 52 (55) 5390 5530

Morocco: Somfy Maroc

Tel: +212-22443500
Fax: +212-22443523

Netherlands: Somfy BV

Tel: +31 (0) 23 55 44 900
Fax: +31 (0) 23 56 15 823

Norway: Somfy Nordic Norge

Tel: +47 41 57 66 39
Fax: +47 67 97 96 21

Poland: Somfy Sp. zo.o.

Tel: +48 (22) 50 95 300
Fax: +48 (22) 50 95 301

Portugal: Somfy Portugal

Tel. +351 229 396 840
Fax. +351 229 396 849

Romania: Somfy SRL

Tel.: +40 - (0)368 - 444 081
Fax: +40 - (0)368 - 444 082

Russia: Somfy LLC. Storozhevaya

Tel: +7 495 781 47 72
Fax: +7 495 781 47 73

Serbia: SOMFY Predstavništvo

Tel: 00381 (0)25 841 510

Singapore: Somfy PTE Ltd

Tel: +65 (0) 6383 3855
Fax: +65 (0) 6383 4933

Slovak republic: Somfy, spol. s r.o.

Tel: +421 337 718 638
Tel: +421 905 455 259
Fax: +421 337 718 639

South Korea: Somfy JOO

Tel: +82 (0) 2594 4331
Fax: +82 (0) 2594 4332

Spain: Somfy Espana SA

Tel: +34 (0) 934 800 900
Fax: +34 (0) 933 770 396

Sweden: Somfy Nordic AB

Tel: +46 (0) 40 16 59 00
Fax: +46 (0) 40 16 59 27

Switzerland: Somfy A.G.

Tel: +41 (0) 44 838 40 30
Fax: +41 (0) 44 836 41 95

Syria: Somfy Syria

Tel: +963-9-55580700

Taiwan: Somfy Development and.

Tel: +886 (0) 2 8509 8934
Fax: +886 (0) 2 2532 4680

Thailand: Bangkok Regional Office

Tel: +66 (0) 2714 3170

Tunisia: Somfy Tunisia

Tel: +216-98303603

Turkey: Somfy Turkey/Mah.,

Fahrettin Tel: +90 (0) 216 651 30 15
Fax : +90 (0) 216 651 30 17

United Arab Emirates: Somfy Gulf

Tel: +971 (0) 4 88 32 808
Fax: +971 (0) 4 88 32 809

United Kingdom: Somfy Limited

Tel: +44 (0) 113 391 3030
Fax: +44 (0) 1133913010

United States: Somfy Systems

Tel: +1 (0) 609 395 1300
Fax: +1 (0) 609 395 1776

